



About Us	News	Industries Served	Products	Services We Offer	Installation	24-Hour Service	Employment	Contact Us
----------	------	-------------------	----------	-------------------	--------------	-----------------	------------	------------

Material Handling Solutions That Work!
CONTACT US
410-379-2700

Conveyor Solutions

- › Integrated Conveyor Systems
- › High Speed Sortation
- › Vertical Conveyor
- › Carousels
- › Tabletop

Storage Solutions

- › Pallet Rack
- › Wire Decking
- › Flow Rack
- › Push-Back Rack
- › Drive-In Rack
- › Carton Flow
- › Shelving
- › Mezzanines

Allied Solutions

- › Modular Offices
- › Wire Partitions
- › Dock Equipment
- › Ergonomic Lift Equipment
- › Pallet Jacks
- › Workstations
- › Rolling Ladders
- › Casters
- › Ramps

Pallet Handling

- › Palletizers
- › Robotic
- › Stretch Wrapper
- › Turntable

Picking Solutions

- › Pick To Light
- › Put To Light
- › Voice Activated Systems
- › Warehouse Management Systems

Engineering

- › Facility Planning
- › Computer Aided Design
- › Layout Assistance

Installation & Service

- › 24-Hour Service
- › Special Fabrication
- › Controls and Wiring

Get the latest information from CHC... ['LIKE' us on Facebook](#)



HOW TO CHANGE AN AIR BAG IN THE BRAKE SYSTEM

Ask Hytrol is our monthly video series focused on specific topics to help you maintain your conveyor system and learn about new technology. In this video, you will learn how to **change an air bag in the brake system** on your conveyor.

For more maintenance tips and information contact your Hytrol solutions provider, [Conveyor Handling](#), at 410-379-2700.

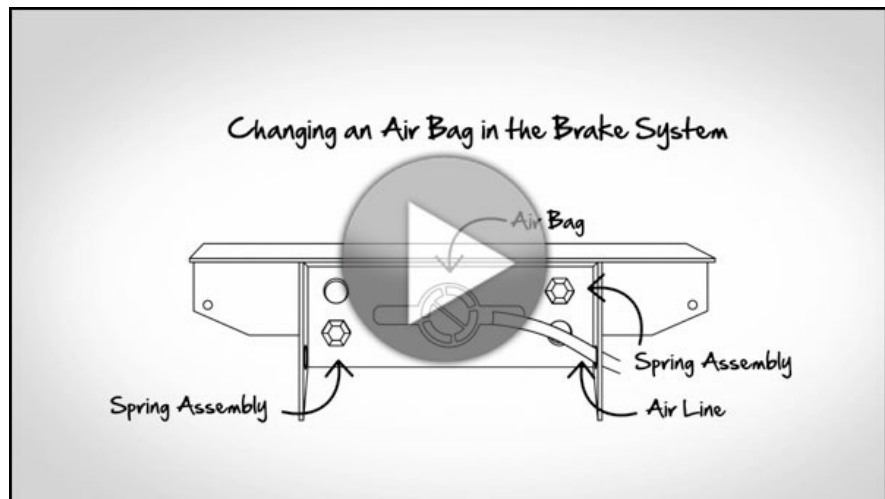

Begin by taking out the rollers that hold the brake in place and removing the airline connected to the air bag. Once this is done, take two 1/2" wrenches and dismantle the spring assembly. From here, you can switch out the air bag.

Before reapplying the airline, snip it to reveal a fresh end. Then, as you insert it on the air bag, make sure it is placed through the correct hole in the brake. This is important as it ensures that the spring will not pinch the line while the conveyor is in use.

Next, reconstruct the spring assembly. Start with inserting the spacer and then sliding the bolt through. Place the spring and washer over the bolt, then tighten the bolt until it is flush with the nut.

For more maintenance tips and information, please contact your Hytrol solutions provider.

Visit Conveyor Handling at www.conveyorhandling.com
or call 410-379-2700 today for more
maintenance tips & information!